



**DANIAMANT**

## **LJ2 lifejacket light**

### Installation and Maintenance Instructions



#### **Introduction**

LJ2 is a two-piece manually-activated versatile light designed for rapid attachment to lifejackets using a variety of fixing methods

#### **Daniamant Limited**

Unit 3, The Admiral Park, Airport Service Road, Portsmouth, UK PO3 5RQ  
Telephone: +44 (0)23 9267 5100 Facsimile: +44 (0) 239267 5101  
[www.daniamant.com](http://www.daniamant.com)  
51-7005 Issue 8 (C6267)



## Installation

Installation methods are shown below. Accessories are supplied to clip into the base of the lamp housing to assist attachment.

- Fixing Plate A flat disc with protruding tabs, suitable for material up to 3mm thick. Requires two 6mm holes at 30mm centres.
- Hanger Plate Allows the lampholder to be attached to a button.
- Crocodile Clip Spring loaded jaws to clip onto webbing, tape or any suitable material.

## Maintenance

### Routine service and battery replacement

The LJ2 is maintenance free; an annual check is recommended:

1. Check date on battery pack. Battery packs must be replaced not more than 5 years after date of manufacture. (Standard replacement part 51-A208).
2. Inspect light and batteries for signs of damage or corrosion. Lightly grease battery connector 'O' ring with silicone grease and replace connector. Using a suitable pointed tool, depress the test plunger as shown on Page 4 and check that the light operates. The test plunger is in the centre of the activator at the top of the battery housing; it is designed to allow testing without breaking the tamper seal. If the unit is damaged or corrosion is visible the unit is to be replaced.
3. Remove pull tag or toggle from LJ2 battery pack – light should illuminate immediately. If light fails to operate, replace light and cable assembly with a checked unit. If light operates, replace toggle in battery pack; test is complete.

### After use

Battery pack, light and cable assembly must be changed after use.

## Safety

The LJ2 battery contains Lithium. This must be handled correctly:

- Do not incinerate, recharge or dismantle battery pack
- Do not make any external electrical connection
- Store between  $-30^{\circ}\text{C}$  and  $+65^{\circ}\text{C}$

## Health and Safety information

Daniamant lithium-powered marine safety light systems have a design life of 5 years. The batteries are hermetically sealed pressurised primary lithium/sulphur dioxide cells, electrically protected by diodes and fuse and environmentally protected by a moulded plastic housing. In this condition batteries present no definable hazard to health.

Information on the composition and behaviour of these products is contained in the Product Safety Data Sheet, available from our website ([www.daniamant.com](http://www.daniamant.com)) or on request.

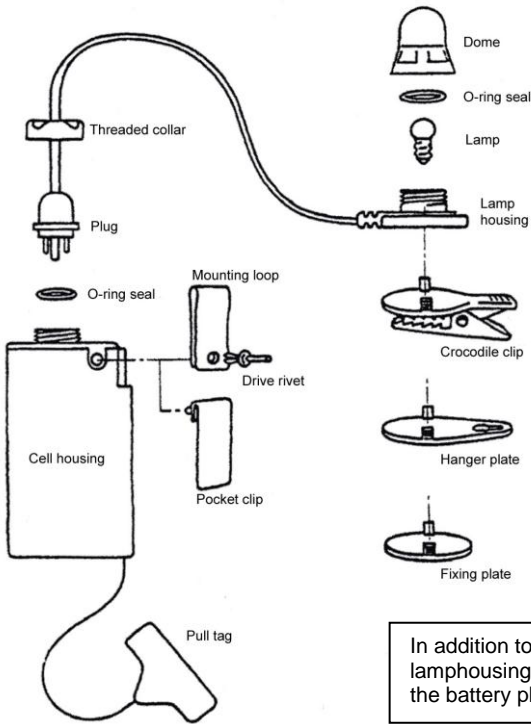

In addition to the accessories shown, the lamphousing may be sewn in position and the battery placed in a pocket.

### Testing and switch activation

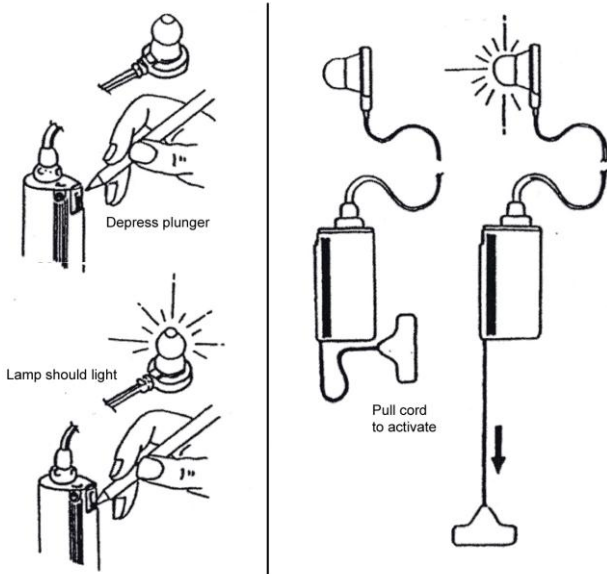

The pull tag must have a direct pull and not be pulled at an angle.

## Product Disposal Instructions

The symbol shown here and on the product means that the product is classed as Electrical or Electronic Equipment and should not be disposed with other household or commercial waste at the end of its working life.



The Waste Electrical and Electronic Equipment Regulations 2006 (the WEEE Regulations) transpose the WEEE Directive (2002/96/EC) into UK law. They have been put into place to ensure that producers fund the cost of collection, treatment, recovery and environmentally sound disposal of WEEE, thereby minimising the impact of such waste on the environment and reducing the amount of waste going to landfill.

To ensure compliance with the WEEE Regulations, the Survivor Location Light should be returned to Daniamant or deposited in your nearest WEEE Designated Collection Facility, operated by your Local Authority. From 2010, it will also be a requirement to recycle batteries and, therefore, it is recommended that, from 1 February 2010, all batteries are deposited at your nearest battery collection point. Please contact your Local Authority or visit the Daniamant website at [www.daniamant.com](http://www.daniamant.com) for contact details.

Further copies of this installation and maintenance instructions are available to download from our website [www.daniamant.com](http://www.daniamant.com)

A copy of these instructions must be held with the ships/owners training manual.